

PT-6601

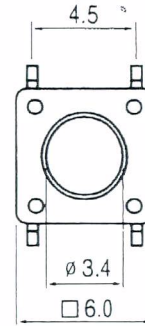
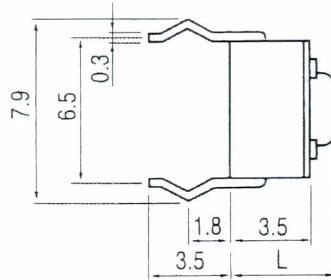
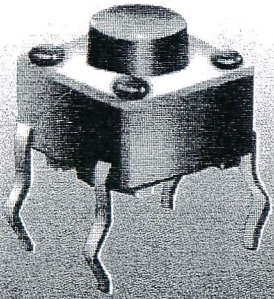

1. Rating : DC 12V. 50mA
2. Travel : 0.25 ± 0.1 m/m
3. Operating Force
: 130, 160 or 250 ± 30 gf
4. Contact Resistance : 50m Ω Max
5. Life : 100,000 Cycles Min

Model No.	L
PT6601	4.3
PT6601A	5.0
PT6601B	7.0
PT6601C	8.0
PT6601D	9.5
PT6601E	7.3
PT6601F	12.5
PT6601G	13.5